

Profilo: Profilo Tr = 30 anni
 Scala : 2000:200
 Q.Rif. : 30.00

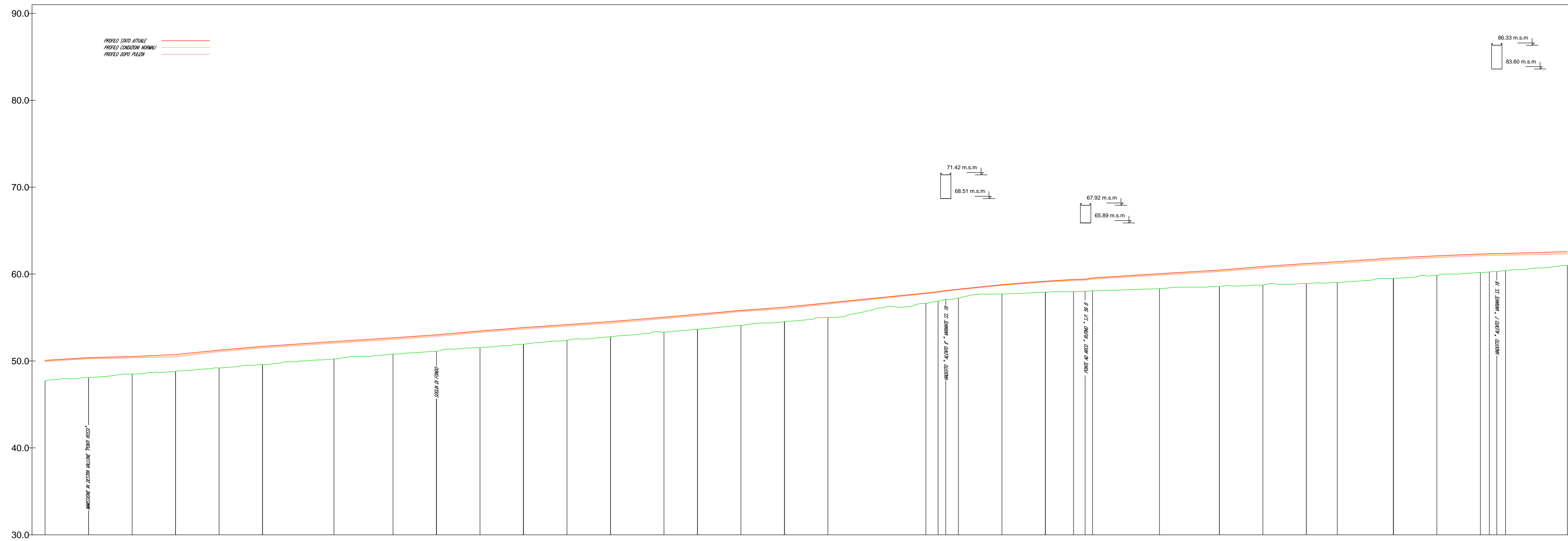

NUMERO SEZIONE	345	346	347	348	349	350	351	352	353	354	355	356	357	358	359	360	361	362	363	364	365	366	367	368	369	370	371	372	373	374	375	376	377	378	379	380	381																
DISTANZE PROGRESSIVE	0+00	0+05	0+10	0+15	0+20	0+25	0+30	0+35	0+40	0+45	0+50	0+55	0+60	0+65	0+70	0+75	0+80	0+85	0+90	0+95	1+00	1+05	1+10	1+15	1+20	1+25	1+30	1+35	1+40	1+45	1+50	1+55	1+60	1+65	1+70	1+75	1+80	1+85	1+90	1+95	2+00												
DISTANZE PARZIALI		5M	10M	15M	20M	25M	30M	35M	40M	45M	50M	55M	60M	65M	70M	75M	80M	85M	90M	95M	100M	105M	110M	115M	120M	125M	130M	135M	140M	145M	150M	155M	160M	165M	170M	175M	180M	185M	190M	195M	200M												
QUOTE FONDO	37.0	37.5	38.0	38.5	39.0	39.5	40.0	40.5	41.0	41.5	42.0	42.5	43.0	43.5	44.0	44.5	45.0	45.5	46.0	46.5	47.0	47.5	48.0	48.5	49.0	49.5	50.0	50.5	51.0	51.5	52.0	52.5	53.0	53.5	54.0	54.5	55.0	55.5	56.0	56.5	57.0	57.5	58.0										
QUOTE IDRICHE-STATO ATTUALE	50.0	50.5	51.0	51.5	52.0	52.5	53.0	53.5	54.0	54.5	55.0	55.5	56.0	56.5	57.0	57.5	58.0	58.5	59.0	59.5	60.0	60.5	61.0	61.5	62.0	62.5	63.0	63.5	64.0	64.5	65.0	65.5	66.0	66.5	67.0	67.5	68.0	68.5	69.0	69.5	70.0	70.5	71.0	71.5	72.0								
QUOTE IDRICHE-IN CONDIZIONI NORMALI	48.0	48.5	49.0	49.5	50.0	50.5	51.0	51.5	52.0	52.5	53.0	53.5	54.0	54.5	55.0	55.5	56.0	56.5	57.0	57.5	58.0	58.5	59.0	59.5	60.0	60.5	61.0	61.5	62.0	62.5	63.0	63.5	64.0	64.5	65.0	65.5	66.0	66.5	67.0	67.5	68.0	68.5	69.0	69.5	70.0	70.5	71.0	71.5	72.0				
QUOTE IDRICHE-DOPO PULIZIA	46.0	46.5	47.0	47.5	48.0	48.5	49.0	49.5	50.0	50.5	51.0	51.5	52.0	52.5	53.0	53.5	54.0	54.5	55.0	55.5	56.0	56.5	57.0	57.5	58.0	58.5	59.0	59.5	60.0	60.5	61.0	61.5	62.0	62.5	63.0	63.5	64.0	64.5	65.0	65.5	66.0	66.5	67.0	67.5	68.0	68.5	69.0	69.5	70.0	70.5	71.0	71.5	72.0

Profilo: Profilo Tr = 30 anni
 Scala : 2000:200
 Q.Rif. : 20.00

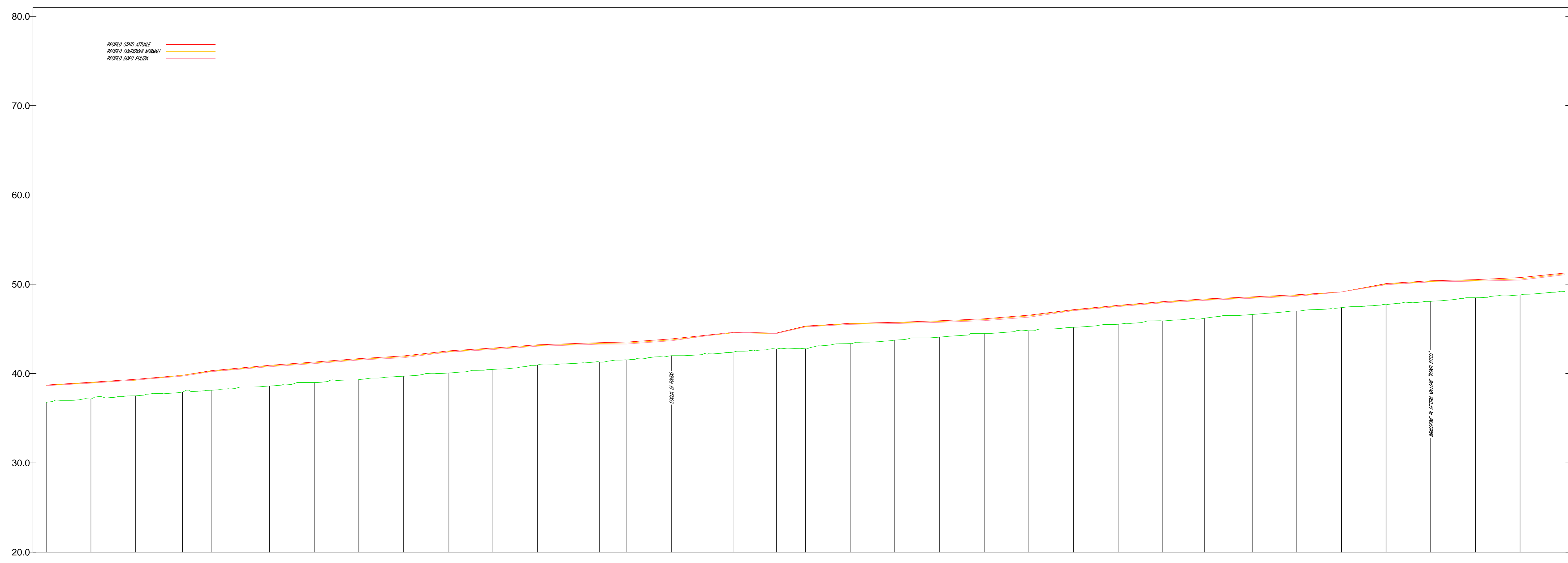

NUMERO SEZIONE	315	316	317	318	319	320	321	322	323	324	325	326	327	328	329	330	331	332	333	334	335	336	337	338	339	340	341	342	343	344	345	346	347	348	349	350	351	352	353	354	355	356	357	358	359	360	361	362	363	364	365	366	367	368	369	370	371	372	373	374	375	376	377	378	379	380	381																						
DISTANZE PROGRESSIVE	0+00	0+05	0+10	0+15	0+20	0+25	0+30	0+35	0+40	0+45	0+50	0+55	0+60	0+65	0+70	0+75	0+80	0+85	0+90	0+95	1+00	1+05	1+10	1+15	1+20	1+25	1+30	1+35	1+40	1+45	1+50	1+55	1+60	1+65	1+70	1+75	1+80	1+85	1+90	1+95	2+00	2+05	2+10	2+15	2+20	2+25	2+30	2+35	2+40	2+45	2+50	2+55	2+60	2+65	2+70	2+75	2+80	2+85	2+90	2+95	3+00																												
DISTANZE PARZIALI		5M	10M	15M	20M	25M	30M	35M	40M	45M	50M	55M	60M	65M	70M	75M	80M	85M	90M	95M	100M	105M	110M	115M	120M	125M	130M	135M	140M	145M	150M	155M	160M	165M	170M	175M	180M	185M	190M	195M	200M	205M	210M	215M	220M	225M	230M	235M	240M	245M	250M	255M	260M	265M	270M	275M	280M	285M	290M	295M	300M	305M	310M	315M	320M	325M	330M	335M	340M	345M	350M	355M	360M	365M	370M	375M	380M	381M											
QUOTE FONDO	37.0	37.5	38.0	38.5	39.0	39.5	40.0	40.5	41.0	41.5	42.0	42.5	43.0	43.5	44.0	44.5	45.0	45.5	46.0	46.5	47.0	47.5	48.0	48.5	49.0	49.5	50.0	50.5	51.0	51.5	52.0	52.5	53.0	53.5	54.0	54.5	55.0	55.5	56.0	56.5	57.0	57.5	58.0	58.5	59.0	59.5	60.0	60.5	61.0	61.5	62.0	62.5	63.0	63.5	64.0	64.5	65.0	65.5	66.0	66.5	67.0	67.5	68.0	68.5	69.0	69.5	70.0	70.5	71.0	71.5	72.0	72.5	73.0	73.5	74.0	74.5	75.0	75.5	76.0	76.5	77.0	77.5	78.0	78.5	79.0	79.5	80.0		
QUOTE IDRICHE-STATO ATTUALE	50.0	50.5	51.0	51.5	52.0	52.5	53.0	53.5	54.0	54.5	55.0	55.5	56.0	56.5	57.0	57.5	58.0	58.5	59.0	59.5	60.0	60.5	61.0	61.5	62.0	62.5	63.0	63.5	64.0	64.5	65.0	65.5	66.0	66.5	67.0	67.5	68.0	68.5	69.0	69.5	70.0	70.5	71.0	71.5	72.0	72.5	73.0	73.5	74.0	74.5	75.0	75.5	76.0	76.5	77.0	77.5	78.0	78.5	79.0	79.5	80.0	80.5	81.0	81.5	82.0	82.5	83.0	83.5	84.0	84.5	85.0	85.5	86.0	86.5	87.0	87.5	88.0	88.5	89.0	89.5	90.0								
QUOTE IDRICHE-IN CONDIZIONI NORMALI	48.0	48.5	49.0	49.5	50.0	50.5	51.0	51.5	52.0	52.5	53.0	53.5	54.0	54.5	55.0	55.5	56.0	56.5	57.0	57.5	58.0	58.5	59.0	59.5	60.0	60.5	61.0	61.5	62.0	62.5	63.0	63.5	64.0	64.5	65.0	65.5	66.0	66.5	67.0	67.5	68.0	68.5	69.0	69.5	70.0	70.5	71.0	71.5	72.0	72.5	73.0	73.5	74.0	74.5	75.0	75.5	76.0	76.5	77.0	77.5	78.0	78.5	79.0	79.5	80.0	80.5	81.0	81.5	82.0	82.5	83.0	83.5	84.0	84.5	85.0	85.5	86.0	86.5	87.0	87.5	88.0	88.5	89.0	89.5	90.0				
QUOTE IDRICHE-DOPO PULIZIA	46.0	46.5	47.0	47.5	48.0	48.5	49.0	49.5	50.0	50.5	51.0	51.5	52.0	52.5	53.0	53.5	54.0	54.5	55.0	55.5	56.0	56.5	57.0	57.5	58.0	58.5	59.0	59.5	60.0	60.5	61.0	61.5	62.0	62.5	63.0	63.5	64.0	64.5	65.0	65.5	66.0	66.5	67.0	67.5	68.0	68.5	69.0	69.5	70.0	70.5	71.0	71.5	72.0	72.5	73.0	73.5	74.0	74.5	75.0	75.5	76.0	76.5	77.0	77.5	78.0	78.5	79.0	79.5	80.0	80.5	81.0	81.5	82.0	82.5	83.0	83.5	84.0	84.5	85.0	85.5	86.0	86.5	87.0	87.5	88.0	88.5	89.0	89.5	90.0

Progetto cofinanziato dal FSC Campania 2014-2020

CONSORZIO DI BONIFICA "VELIA"

Località Piano della Rocca, 84060 - Prignano Cilento (SA)
 Tel. 0974/837206 - Fax. 0974/837154 - Pec: consorziovelia@pec.it - www.consorziovelia.com

PIANO STRAORDINARIO DI DIFESA IDROGEOLOGICA DEGLI ALVEI NATURALI NEI BACINI DEL FIUME ALENTO E DELLA FIUMARELLA DI ASCEA

Interventi integrati di mitigazione del rischio idrogeologico e di tutela e recupero degli ecosistemi e della biodiversità dei bacini del fiume Alento e della Fiumarella di Ascea

1° LOTTO ESECUTIVO

Livello di progettazione: Fattib. tecnico - economica Progetto definitivo Progetto esecutivo

Cod. elaborato: H3.2b | Scala: 1:2.000/200 | Data: Giugno 2023 | Revisione:

Are di allagamento (tempo di ritorno 30 anni)

Profili (sez. 381 - sez.345 / sez. 349 - sez. 315)

TIPOLOGIA ELABORATO
 Economico Sicurezza Discipline/Contrattuale Altro

Descrittivo Grafico Calcolo

PROGETTISTA
 Velia Ingegneria e Servizi Srl
 Ing. Gaetano Suppa
iscritto all'Albo degli Ingegneri di Salerno n. 1184 dal 12.09.1983

R.U.P.
 Consorzio di Bonifica "Velia"
 Ing. Marcello Nicodemo
iscritto all'Albo degli Ingegneri di Salerno n. 1931 dal 14.04.1984

GEOLOGO
 Dott. Geol. Vincenzo Silvo
iscritto all'Albo dei Geologi della Regione Campania n. 1318 dal 08.09.1995

Riferimenti archivio digitale: N.34b.2019/Ve.Ing. | CUP: E16J16001960005