

Profilo: Profilo Tr = 100 anni  
 Scala : 2000:200  
 Q.Rif. : 10.00

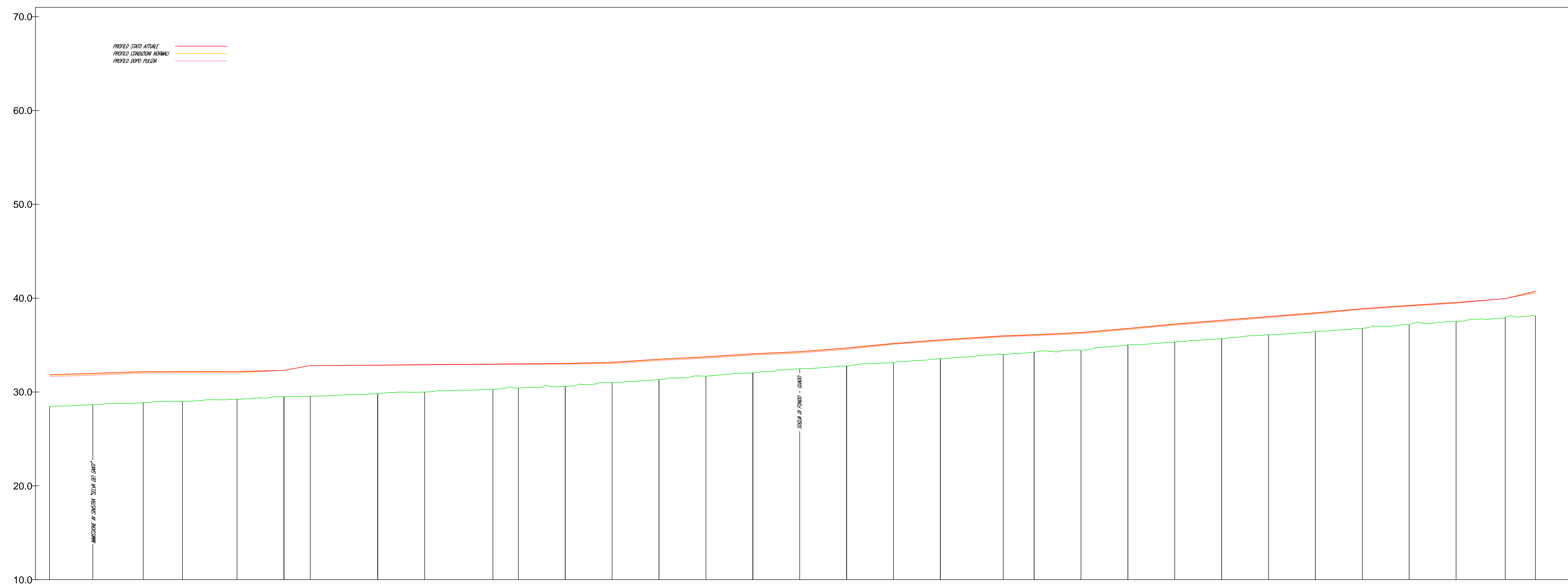

NUMERO SEZIONE	207	208	209	210	211	212	213	214	215	216	217	218	219
DISTANZE PROGRESSIVE	0+00	0+00	0+00	0+00	0+00	0+00	0+00	0+00	0+00	0+00	0+00	0+00	0+00
DISTANZE PARZIALI		45,4	52,8	41,8	35,2	30,0	30,0	71,6	30,0	30,0	30,0	30,0	30,0
QUOTE FONDO	28,0	28,0	28,0	28,0	28,0	28,0	28,0	28,0	28,0	28,0	28,0	28,0	28,0
QUOTE IDRICHE-STATO ATTUALE	28,0	28,0	28,0	28,0	28,0	28,0	28,0	28,0	28,0	28,0	28,0	28,0	28,0
QUOTE IDRICHE-IN CONDIZIONI NORMALI	28,0	28,0	28,0	28,0	28,0	28,0	28,0	28,0	28,0	28,0	28,0	28,0	28,0
QUOTE IDRICHE-DOPO PULIZIA	28,0	28,0	28,0	28,0	28,0	28,0	28,0	28,0	28,0	28,0	28,0	28,0	28,0

Profilo: Profilo Tr = 100 anni  
 Scala : 2000:200  
 Q.Rif. : 0.00

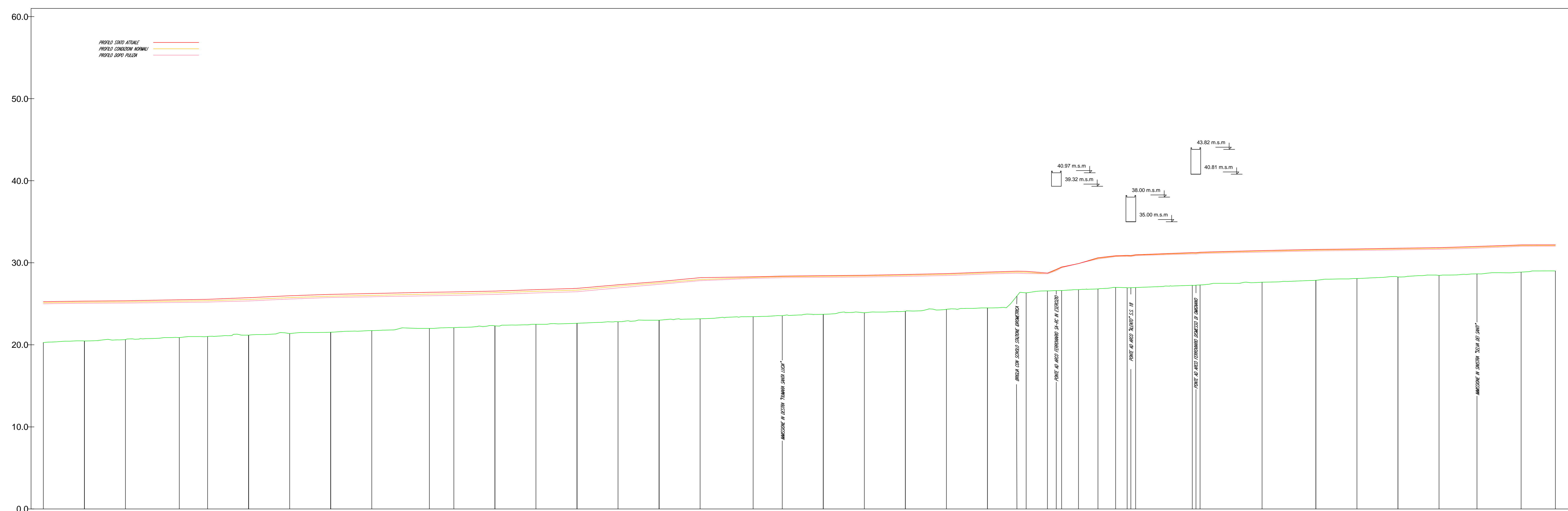

NUMERO SEZIONE	245	246	247	248	249	250	251	252	253	254	255	256	257	258	259	260	261	262	263	264	265	266	267	268	269	270	271	272	273	274	275	276	277	278	279	280		
DISTANZE PROGRESSIVE	0+00	0+00	0+00	0+00	0+00	0+00	0+00	0+00	0+00	0+00	0+00	0+00	0+00	0+00	0+00	0+00	0+00	0+00	0+00	0+00	0+00	0+00	0+00	0+00	0+00	0+00	0+00	0+00	0+00	0+00	0+00	0+00	0+00	0+00	0+00	0+00	0+00	0+00
DISTANZE PARZIALI		30,0	30,0	45,4	34,4	30,0	30,0	30,0	30,0	30,0	30,0	30,0	30,0	30,0	30,0	30,0	30,0	30,0	30,0	30,0	30,0	30,0	30,0	30,0	30,0	30,0	30,0	30,0	30,0	30,0	30,0	30,0	30,0	30,0	30,0	30,0	30,0	30,0
QUOTE FONDO	28,0	28,0	28,0	28,0	28,0	28,0	28,0	28,0	28,0	28,0	28,0	28,0	28,0	28,0	28,0	28,0	28,0	28,0	28,0	28,0	28,0	28,0	28,0	28,0	28,0	28,0	28,0	28,0	28,0	28,0	28,0	28,0	28,0	28,0	28,0	28,0	28,0	28,0
QUOTE IDRICHE-STATO ATTUALE	28,0	28,0	28,0	28,0	28,0	28,0	28,0	28,0	28,0	28,0	28,0	28,0	28,0	28,0	28,0	28,0	28,0	28,0	28,0	28,0	28,0	28,0	28,0	28,0	28,0	28,0	28,0	28,0	28,0	28,0	28,0	28,0	28,0	28,0	28,0	28,0	28,0	28,0
QUOTE IDRICHE-IN CONDIZIONI NORMALI	28,0	28,0	28,0	28,0	28,0	28,0	28,0	28,0	28,0	28,0	28,0	28,0	28,0	28,0	28,0	28,0	28,0	28,0	28,0	28,0	28,0	28,0	28,0	28,0	28,0	28,0	28,0	28,0	28,0	28,0	28,0	28,0	28,0	28,0	28,0	28,0	28,0	28,0
QUOTE IDRICHE-DOPO PULIZIA	28,0	28,0	28,0	28,0	28,0	28,0	28,0	28,0	28,0	28,0	28,0	28,0	28,0	28,0	28,0	28,0	28,0	28,0	28,0	28,0	28,0	28,0	28,0	28,0	28,0	28,0	28,0	28,0	28,0	28,0	28,0	28,0	28,0	28,0	28,0	28,0	28,0	28,0

POC 1/28  
REGIONE CAMPANIA

Progetto cofinanziato dal PSC Campania 2014-2020

**CONSORZIO DI BONIFICA "VELIA"**  
 Località Piano della Rocca, 84060 - Prignano Cilento (SA)  
 Tel. 0974/837206 - Fax. 0974/837154 - Pec: consorziovelia@pec.it - www.consorziovelia.com

Interventi integrati di mitigazione del rischio idrogeologico e di tutela e recupero degli ecosistemi e della biodiversità dei bacini del fiume Aliento e della Fiumarella di Ascea

1° LOTTO ESECUTIVO

---

livello di progettazione:  Fattib. tecnico - economica  Progetto definitivo  Progetto esecutivo

Cod. elaborato: H4.2c | Scala: 1:2.000/200 | Data: Giugno 2023 | Revisione:

**Stato elaborato:**  
**Aree di allagamento (tempo di ritorno 100 anni)**  
 Profili (sez. 319 - sez. 287 / sez. 290 - sez. 245)

---

TIPOLOGIA ELABORATO	<input type="checkbox"/> Descrittivo	<input checked="" type="checkbox"/> Grafico	<input type="checkbox"/> Calcolo
	<input type="checkbox"/> Economico	<input type="checkbox"/> Sicurezza	<input type="checkbox"/> Altro
<b>PROGETTISTA</b> Velia Ingegneria e Servizi Srl Ing. Gaetano Suppa <small>iscritto all'Albo degli Ingegneri di Salerno n. 1164 dal 12.09.1993</small>		<b>R.U.P.</b> Consorzio di Bonifica "Velia" Ing. Marcello Nicodemo <small>iscritto all'Albo degli Ingegneri di Salerno n. 1931 dal 14.04.1984</small>	
<b>GEOLOGO</b> Dott. Geol. Vincenzo Siero <small>iscritto all'Albo dei Geologi della Regione Campania n. 1378 dal 08.09.1995</small>			

---

Riferimenti archivio digitale: N.346.2019/Ve/Ing | CUP: E16J16001960005